

Trinitron[®] Color TV

Operating Instructions

*KV-25FXR20
KV-25FXR22
KV-29FXR22*

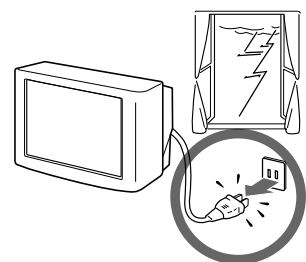
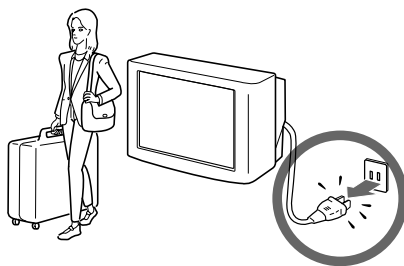
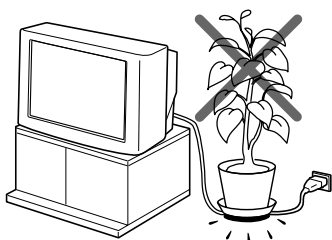
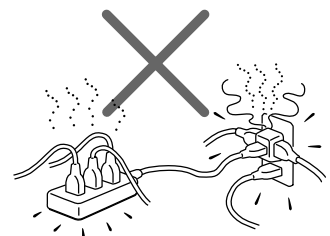
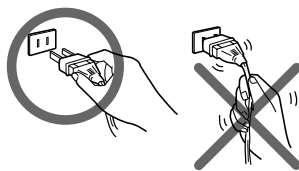
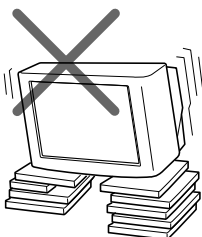
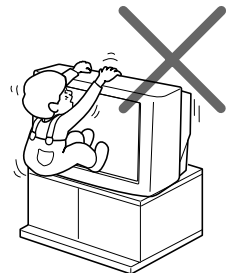
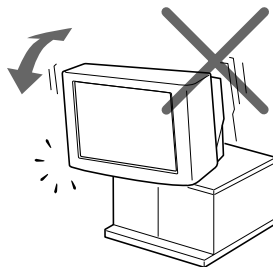
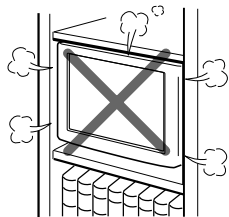
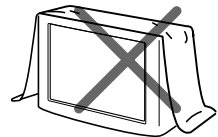
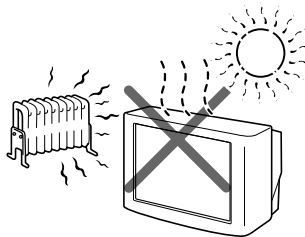
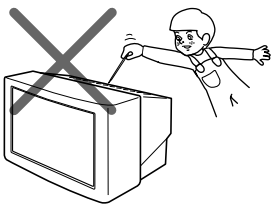
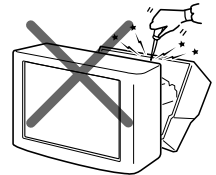
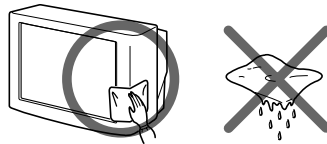
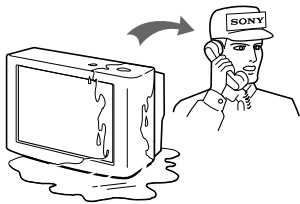
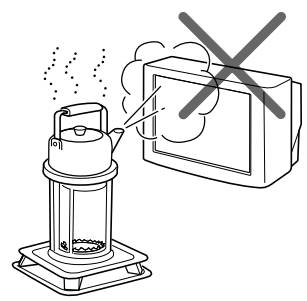
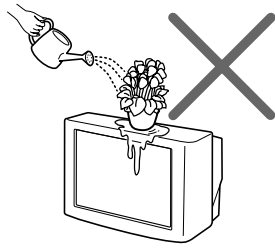
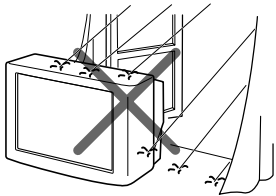

WARNING

- Dangerously high voltages are present inside the TV.
- Operate the TV at 110 – 240 V AC.
- Do not open the cabinet and the rear cover of the TV. Refer servicing to qualified personnel.
- To prevent fire or shock hazard, do not expose the TV to rain or moisture.
- Do not operate the TV if any liquid or solid object falls into it. Have it checked immediately by qualified personnel only.
- Do not block the ventilation openings.
- Do not install the appliance in a confined space, such as a bookcase or built-in cabinet.
- Do not install the TV in hot, humid or excessively dusty places.
- Do not install the TV where it may be exposed to mechanical vibrations.
- Do not keep the TV plugged in if you are not going to use it for several days.
- Do not pull the power cord to disconnect the TV. Pull it out by the plug.
- Use only the supplied screws (as shown below) to fasten the TV to the TV stand or to stabilize the TV against a wall or a pillar. Use of other screws may damage the TV.

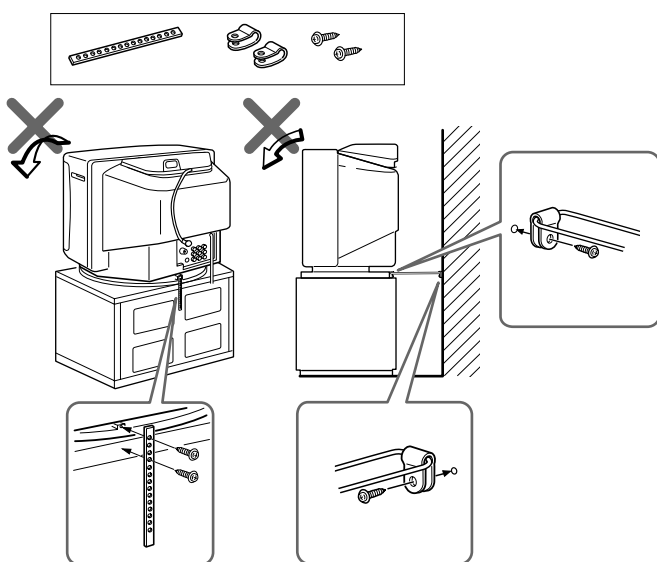

Table of Contents

Getting Started

- 4 Connecting the TV
- 6 Getting to Know the Remote Control
- 7 Presetting Channels

Operations

- 8 Watching a TV Channel
- 10 Adjusting the Picture and Sound

Additional Information

- 11 Troubleshooting
- Back cover
- Specifications

The contents of this manual are subject to change without notice.

Notes

- When you turn on the TV, you may hear the “boon” sound that is caused by the demagnetization of the TV. This does not indicate a malfunction.
- The picture color may become abnormal if you change the direction of your TV. To re-establish the normal picture color, press **POWER** on the TV to turn off the TV for five minutes and then turn it on again.

Connecting the TV

Connecting a VHF antenna or a combination VHF/UHF antenna — 75-ohm coaxial cable (round)

Attach an antenna connector (not supplied) to the 75-ohm coaxial cable. Plug the connector into the Υ (antenna) socket at the rear of the TV.

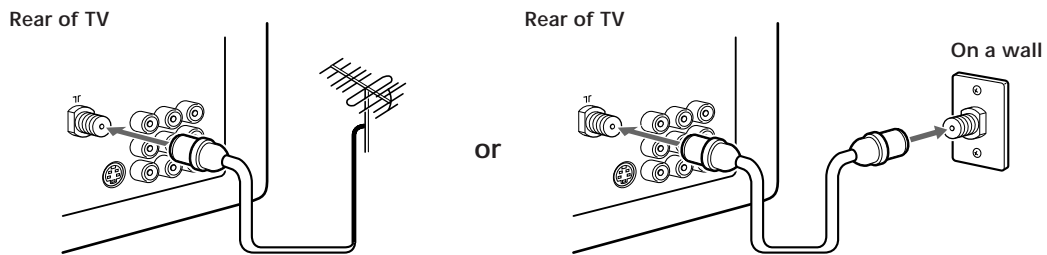

Connecting optional equipment

You can connect optional audio/video equipment, such as a VCR, multi disc player, camcorder, video game or stereo system, to your TV.

Connecting video equipment using the video input jacks

You can connect video equipment to the video input jacks at the rear or front of the TV.

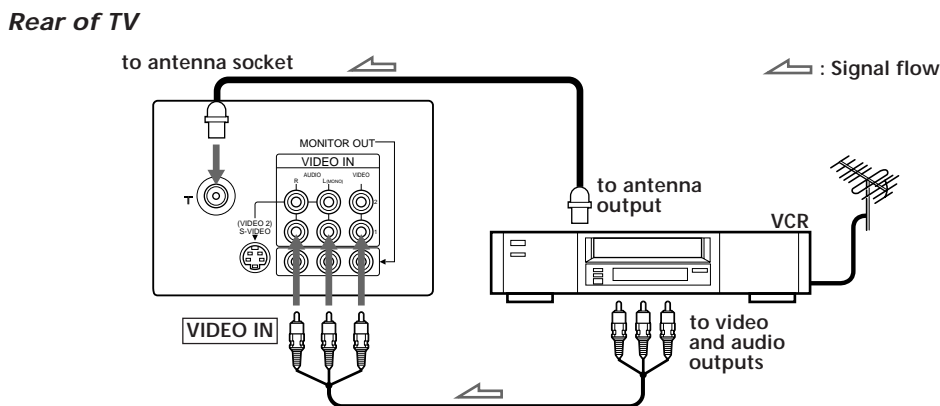

When connecting a monaural VCR

Connect the yellow plug to VIDEO and the black plug to AUDIO-L (MONO).

Front of TV

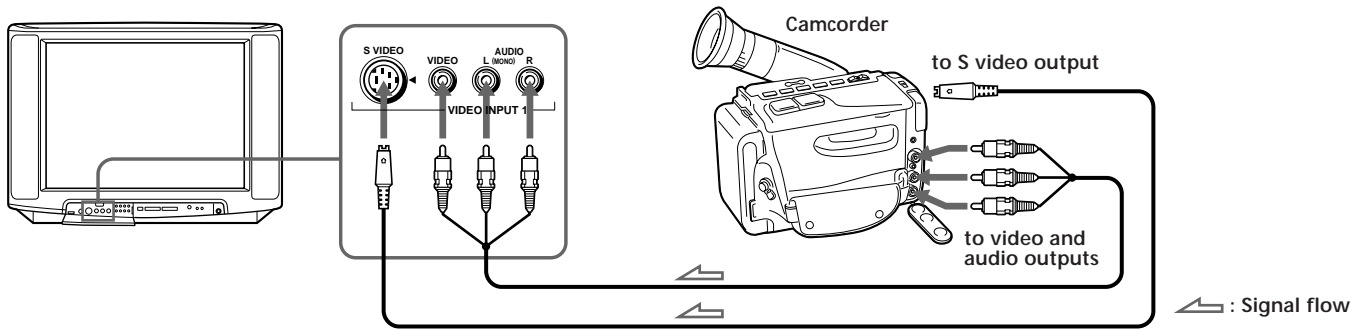

When using the video input jacks on the front of the TV

First, open the cover located on the front panel. Do not connect video equipment to the video input jacks at the front and the rear of your TV at the same time. This type of connection will cause unwanted picture noise.

Connecting audio/video equipment using the MONITOR OUT jacks

Rear of TV

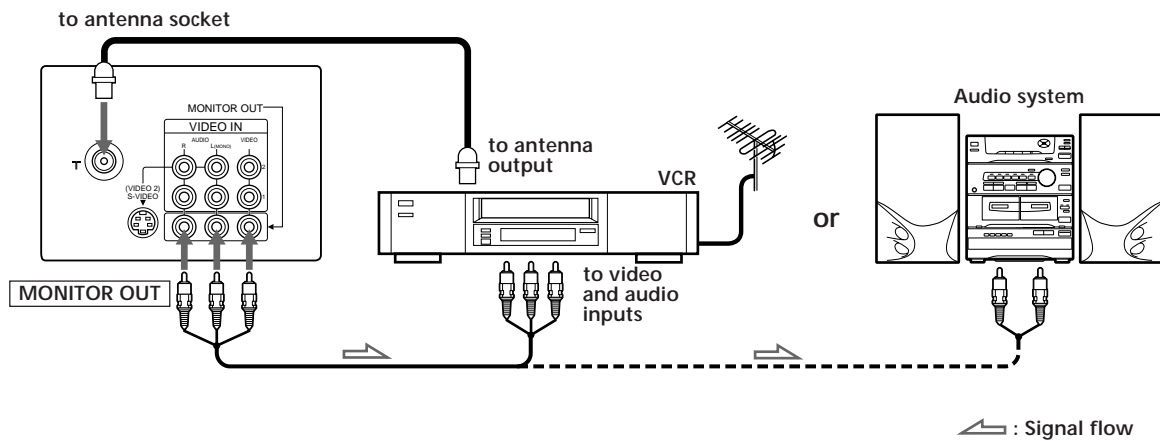

When recording through the MONITOR OUT jacks

If you change the channel or video input while recording with a VCR, the channel or video output you are recording will also be changed.

Note

- Disconnect the S-VIDEO when recording through the MONITOR OUT jacks.
The MONITOR OUT jacks do not supply video signals if you keep S-VIDEO connected.
- The TV is not supplied with the S-VIDEO output.
- To enhance picture quality, connect the S-VIDEO output of the VCR to the S-VIDEO input of the TV.

Getting to Know the Remote Control

Throughout this manual, we will refer to buttons on the remote control. When trying to locate these buttons, use the following illustration as a reference.

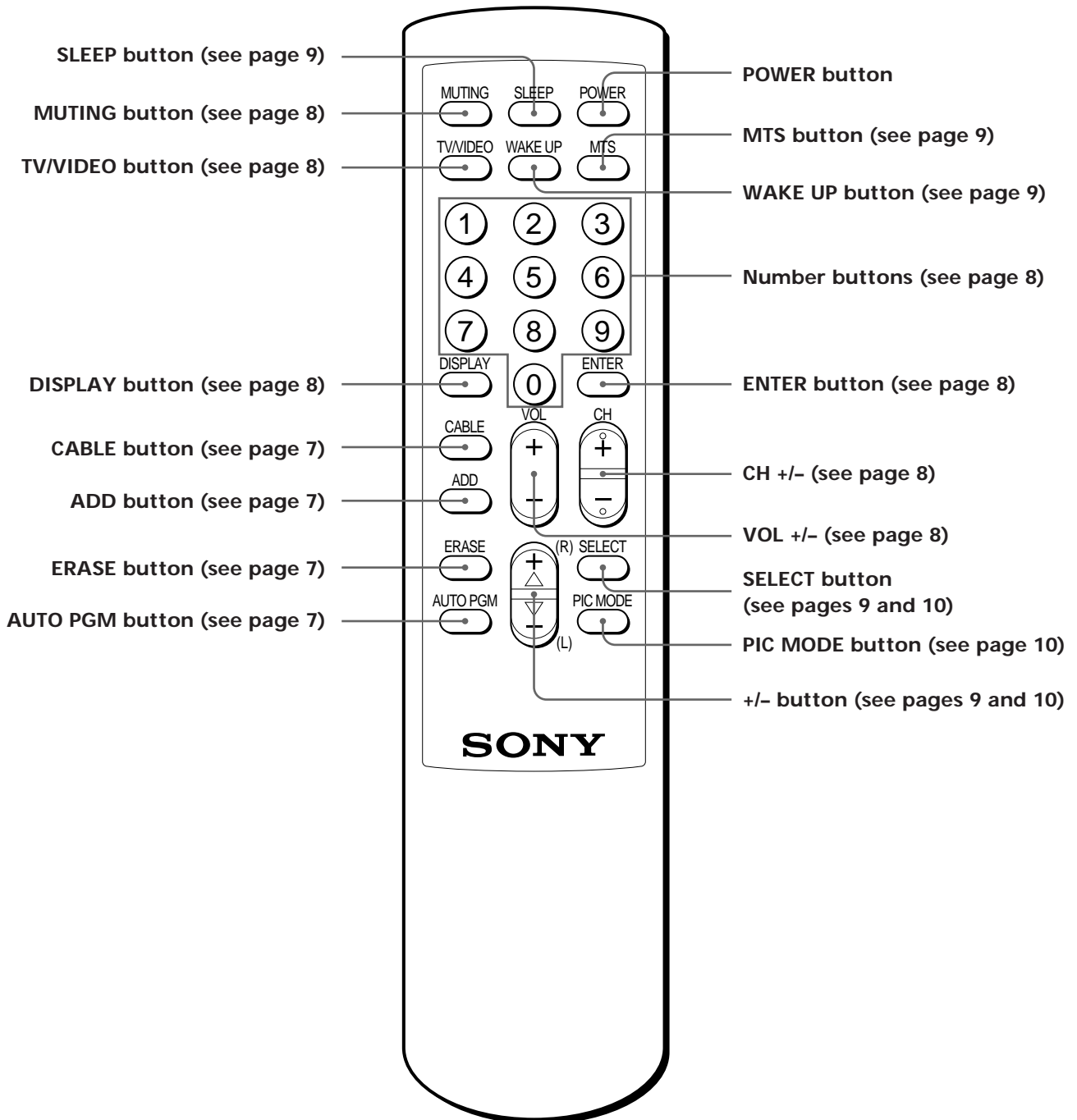

Presetting Channels

Presetting channels automatically

You can preset TV channels in numerical sequence from program position 1.

- 1 Press **POWER**.

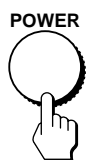

If the TV is in standby mode after you have pressed **POWER**, press **POWER** on the remote control.

- 2 Press **CABLE** to set cable TV on or off.

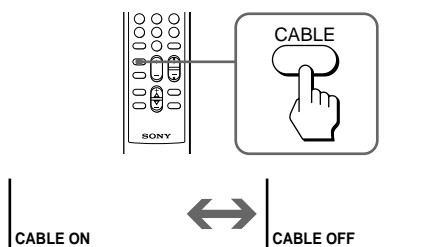

- 3 Press **AUTO PGM.**

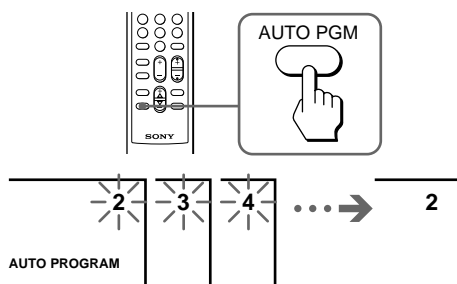

Presetting channels manually

To change the program position for a channel or to receive a channel with a weak signal, preset the channel manually.

- 1 Press **CH +/-** until the channel appears on the screen.
- 2 Press number buttons to select the program position, then press **ENTER**.
- 3 Press **ADD**.
“+” appears beside the channel position number, indicating that presetting is complete.

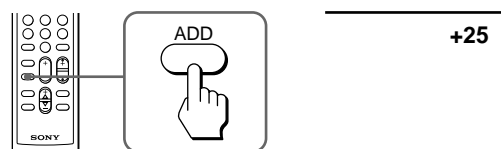

Disabling program positions

By disabling unused or unwanted program positions, you can skip those positions when you press **AUTO PGM +/-**.

- 1 Press **CH +/-** until the unused or unwanted program position appears on the screen, then press **ENTER**.
- 2 Press **ERASE**.
“-” appears beside the channel position number, indicating that disabling is complete.

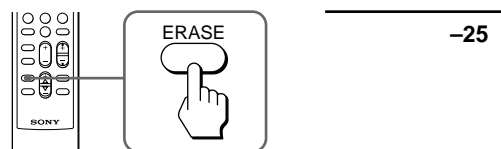

To cancel the skip setting

Preset the channel manually or automatically again.

Watching a TV Channel

1 Press **POWER** to turn on the TV.



If the TV is in standby mode after you have pressed POWER, press POWER on the remote control.

2 Select the TV channel you want to watch.

To select a channel directly

Press a number button.

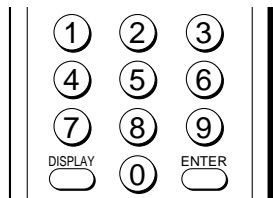

To select a two-digit channel, press the number buttons, then press ENTER.

For example: to select channel 25, press “2” and “5,” then press ENTER.



To scan through channels

Press CH +/- until the channel you want appears.

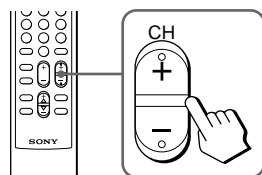

3 Press **VOL +/-** to adjust the volume.

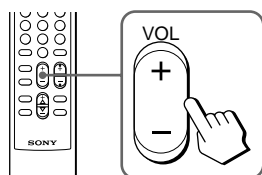

Watching a program through the video input

Press **TV/VIDEO**.

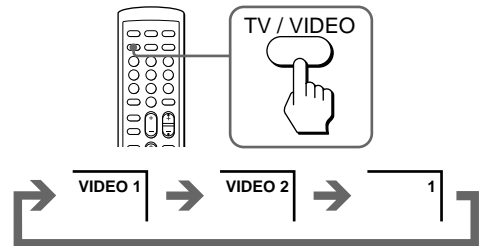

To watch a TV channel, press **TV/VIDEO** again.

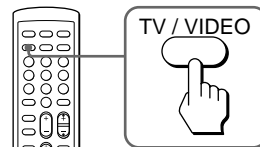

You can also watch a TV channel by pressing **CH +/-** or the number buttons.

Muting the sound

Press **MUTING**.

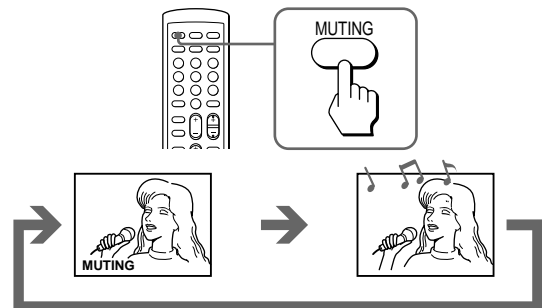

Displaying on-screen information

Press **DISPLAY**.

The program position and TV settings are displayed on the screen.

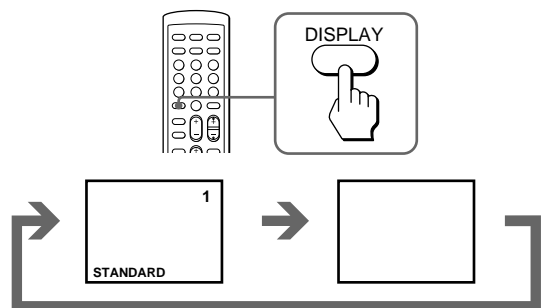

Note

When there is no signal either in TV or VIDEO IN mode, VIDEO or the channel number continues appearing on the screen to remind you.

Selecting a stereo or bilingual program

Press MTS.

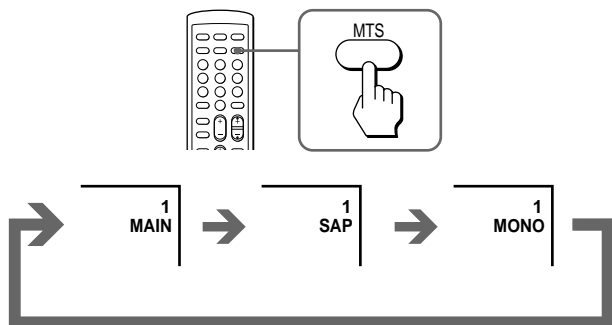

Choose	To
MAIN	Listen to stereo sound. The STEREO indicator on the TV lights up when a stereo broadcast is received.
SAP	Listen to bilingual programs. The sound of non-SAP programs is muted when SAP is selected.
MONO	Reduce noise during stereo broadcasts.

Note

Stereo and SAP sounds are subject to program sources.

Setting the WAKE UP TIMER

You can set the TV to turn on automatically after the period of time you want.

- 1 Press **WAKE UP** repeatedly to cycle through the timer options.
The on-screen display appears and the WAKE UP indicator lights up.

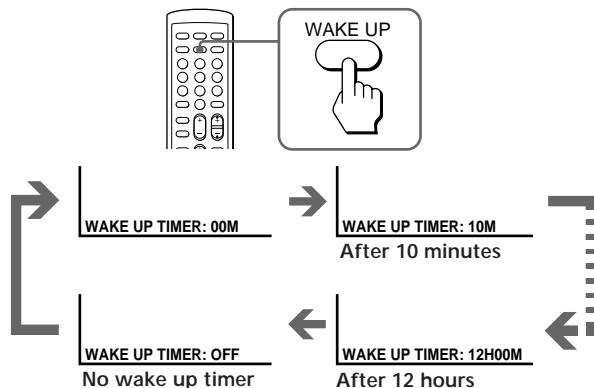

- 2 If you want a particular TV channel or video input to be displayed using the Wake Up Timer, select the TV channel or video mode.
- 3 Press **POWER** on the remote control or set the **SLEEP TIMER** to turn off the TV in standby mode.

To cancel the WAKE UP TIMER, press WAKE UP repeatedly until "WAKE UP TIMER: OFF" appears, or turn off the main power of the TV.

Notes

- The WAKE UP TIMER starts immediately after the on-screen display disappears.
- The last TV program position or video mode displayed just before the TV goes into standby mode appears when the TV turns on using the WAKE UP TIMER.
- If no buttons or controls are pressed for more than two hours after the TV is turned on using the WAKE UP TIMER, the TV automatically goes into standby mode. When you want to continue watching the TV, press any button or control on the TV or remote control.

Setting the SLEEP TIMER

You can set the TV to turn off automatically after the period of time you want.

Press **SLEEP**.

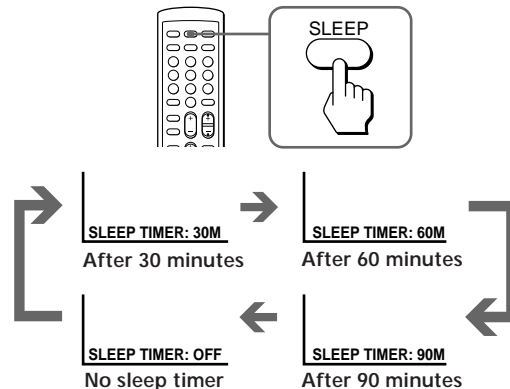

To cancel the SLEEP TIMER, press SLEEP repeatedly until "SLEEP TIMER: OFF" appears, or turn off the TV.

Changing the on-screen display language

If you prefer Chinese to English, you can change the on-screen display language. You can use the buttons on the remote control or the TV.

- 1 Press **SELECT** until the following screen appears.

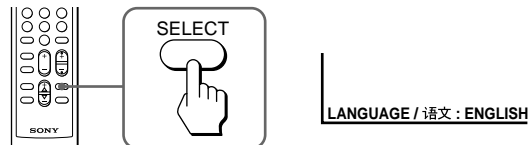

- 2 Press **+** or **-** to select "中文".

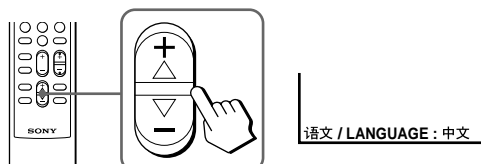

Adjusting the Picture and Sound

Adjusting the picture and sound settings

- 1 Press **SELECT** until the item you want to adjust appears.

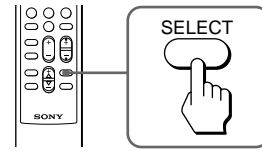

Each time you press **SELECT**, the screen changes as follows:

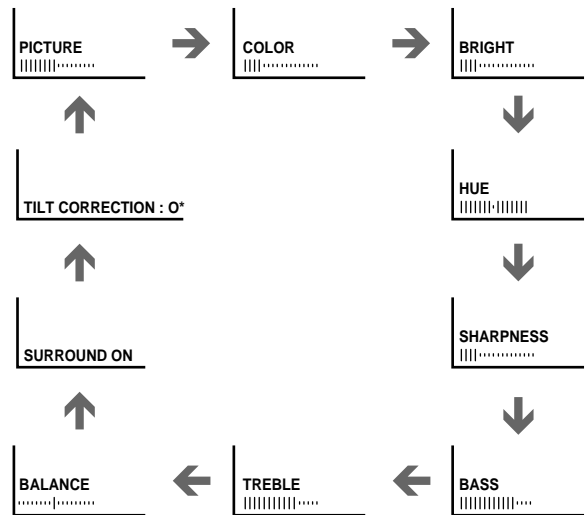

* KV-29FXR22 only

- 2 Press **+** or **-** to adjust the item.

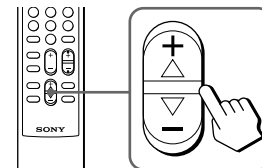

- 3 To adjust other items, repeat steps 1 and 2.

Note

* You can adjust the tilt of the picture if it is not aligned to the TV screen. This may happen due to the direction of the earth's magnetic field in relation to the position of the TV.

TILT CORRECTION : -3 ← -2 ← -1 ← 0 → +1 → +2 → +3
- +

Selecting the picture mode

Press **PIC MODE** until the mode you want appears.

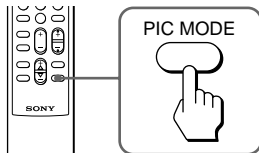

Each time you press **PIC MODE**, the screen changes as follows:

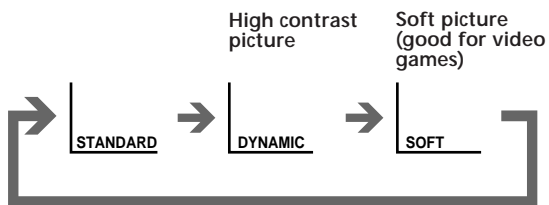

Note

After you have chosen a picture mode, you can adjust the **PICTURE**, **COLOR**, **BRIGHTNESS**, **HUE**, and **SHARPNESS** settings (see "Adjusting the picture and sound settings" below). When you choose a new picture mode, these settings will change in accordance with your choice.

Troubleshooting

If you have any problems, read this manual again and check the countermeasure for each of the symptoms listed below.

If the problem persists, contact your nearest authorized service center or dealer.

Poor picture or no picture (no windows), but sound available

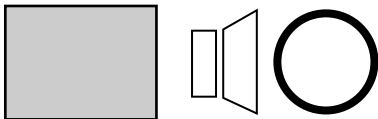

- ➔ Adjust the contrast (PICTURE, page 10).
- ➔ Adjust the brightness (BRIGHTNESS, page 10).
- ➔ Check the antenna or cable connection (page 4).

Snowy picture, Noisy sound

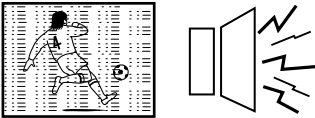

- ➔ Check the antenna (page 4).
- ➔ Check the antenna connection to the TV and to the wall (page 4).
- ➔ Check the antenna or cable connection (page 4).

Dotted lines or stripes



- ➔ This may be caused by local interference (e.g., cars, neon signs, and hair dryers, etc.). Adjust the antenna for minimum interference.

Double images or "ghosts"



- ➔ This may be caused by reflections from nearby mountains or buildings. A highly directional antenna may improve the picture quality.

No picture, No sound

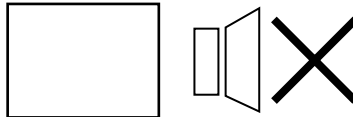

- ➔ Press POWER.
- ➔ Check the antenna connection (page 4).
- ➔ Check the VCR connections (page 4, 5).
- ➔ Check the power cord connection.
- ➔ Check the standby mode.

Good picture, No sound

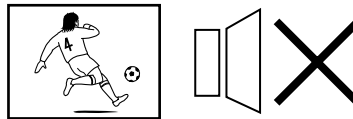

- ➔ Press VOLUME + (page 8).
- ➔ Press MUTING (page 8).
- ➔ Check the MTS setting (page 9).
- ➔ Check the TV/VIDEO setting (page 8).

No color



- ➔ Make sure it is a color TV program.
- ➔ Adjust the COLOR level in the on-screen display (page 10).

TV cabinet creaks

- ➔ Even if the picture or the sound is normal, changes in the room temperature sometimes make the TV cabinet expand or contract, making a noise. This does not indicate a malfunction.

Note on the remote control

The supplied remote control is used with several TV models. If you do not find instructions for some controls on the remote control, your TV does not employ the features of those controls, for example TEXT.

Specifications

	KV-25FXR20	KV-25FXR22	KV-29FXR22
Power requirements	110 V - 240 V, 50/60 Hz		
Power consumption (W)	Indicated on the rear of the TV		
Television system	American TV standard		
Color system	NTSC 3.58		
Channel coverage M	VHF : A2 to A13 / UHF : A14 to A69/ CATV : A-1 to A125		
Antenna	75 ohm external for VHF/UHF		
Audio output Speaker	5 W + 5 W		
Woofers	--	12 W	
Number of terminals			
Video	Input : 2 Phono jacks; 1 Vp-p, 75 ohms		
Audio	Input : 2 Phono jacks; 500 mVrms		
Monitor out	VIDEO OUT × 1, AUDIO OUT × 1 1 MONITOR OUT jacks: phono jacks		
Picture tube (inch)	25		29
Dimensions (w/h/d, mm)	690 × 535 × 510		780 × 593 × 532
Mass (kg)	36	39	52
Supplied accessories	Remote control RM-867 (1) Size R6 (AA) batteries (2)		

Design and specifications are subject to change without notice.