

## Precautions

- Operate the system only on 9 V DC. For AC operation, use only the AC power adaptor (supplied). Do not use any other AC power adaptor.
- After operating the system with the AC power adaptor, disconnect the AC power adaptor from the wall outlet if the system is not to be used for an extended period of time. The POWER switch on the system does not turn the AC power adaptor off.
- Do not open the cabinet. Refer servicing to qualified personnel only.
- Do not leave the system in a location near heat sources, or in a place subject to direct sunlight, excessive dust, moisture, rain or mechanical shock.
- Should any solid object or liquid fall into the system, disconnect the AC power adaptor and have the system checked by qualified personnel before operating it any further.
- Do not use alcohol, benzine or thinner to clean the cabinet.
- Although this system is magnetically shielded, do not leave recorded tapes, watches, personal credit cards or floppy disks using magnetic coding in front of the system for an extended period of time.

## Specifications

### Amplifier section

Power output 1 W + 1 W  
Input impedance 4.7 kilohms (at 1 kHz)

### Speaker section

System Full-range open back type  
Speaker unit Full-range:  
ø 57 mm (2 1/4 in.)

Nominal impedance  
16 ohms

Rated input power  
1 W

Input cord 5 m

### General

#### Power requirement

DC 9 V

Dimensions Approx. 290 × 65 × 190 mm  
(w/h/d)  
(11 1/2 × 2 5/8 × 7 1/2 in.)

Mass Approx. 320 g

#### Supplied accessories

AC power adaptor (1)  
Connecting cord (stereo mini  
jack ↔ phono jacks) (1)

Design and specifications are subject to change without notice.

# SONY

3-860-375-22 (1)

## Active Speaker System

### Operating instructions

Before operating the unit, please read this manual thoroughly and retain it for future reference.

## SRS-GS70

Sony Corporation © 1997 Printed in Japan

## Owner's Record

The model number is located on the front of the unit and the serial number is located at the rear of the unit. Record the serial number in the space provided below. Refer to them whenever you call upon your Sony dealer regarding this product.

Model No. SRS-GS70

Serial No. \_\_\_\_\_

## Features

The Sony SRS-GS70 is a shoulder speaker system that emits powerful vibrational sound on your shoulders while playing personal video games.

## WARNING

To prevent fire or shock hazard, do not expose the unit to rain or moisture.

To avoid electrical shock, do not open the cabinet. Refer servicing to qualified personnel only.

# Connections

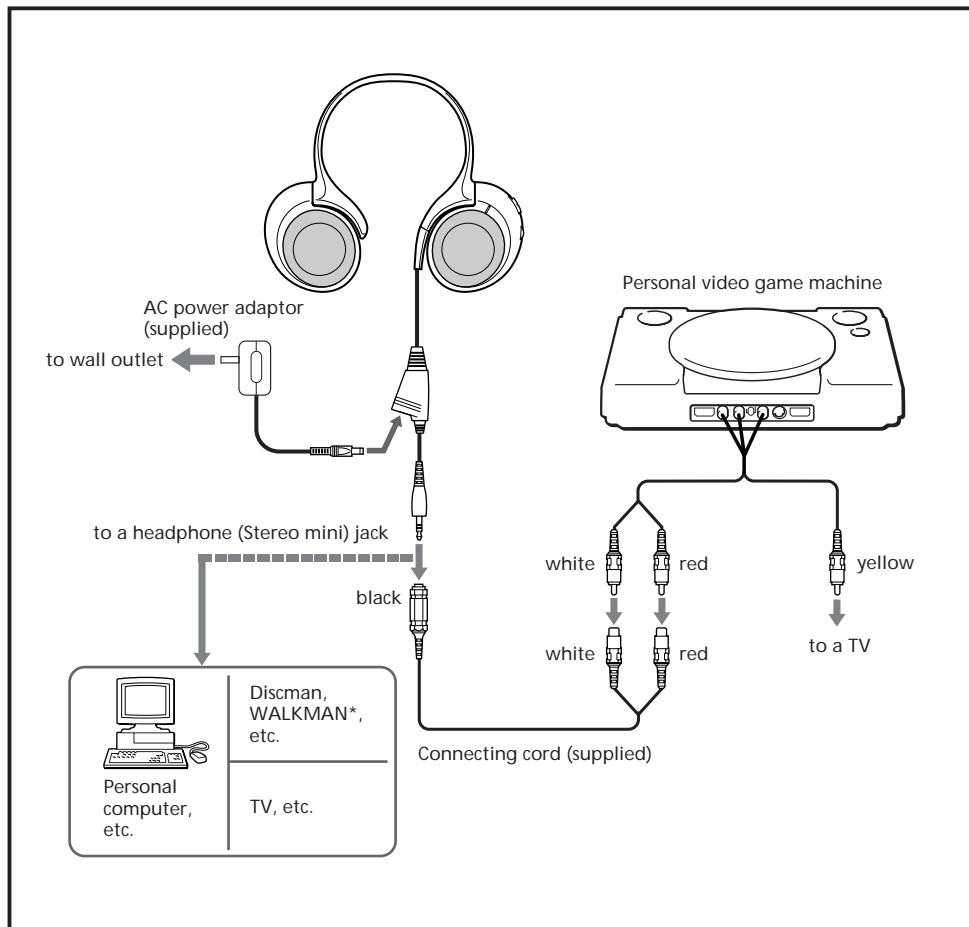

\* WALKMAN is a registered trademark of Sony Corporation.

## Note on the AC power adaptor

Use only the AC-S906 AC power adaptor (supplied). Do not use any other AC power adaptor.



Polarity of the plug

# How to Use

1

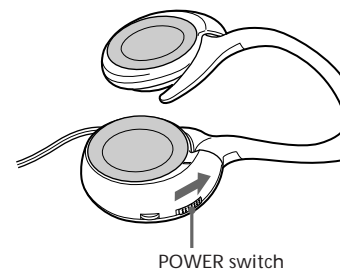

**1 Set the POWER switch to ON.**  
The POWER indicator lights up.

**2 Hang the unit around your shoulders so that the parts of the speaker are right side out.**

**3 Adjust the angle of the speaker.**  
upward (music position)  
→ You can enjoy the sound with presence.  
downward (game position)  
→ You can enjoy the bass sound with vibration.

2



3

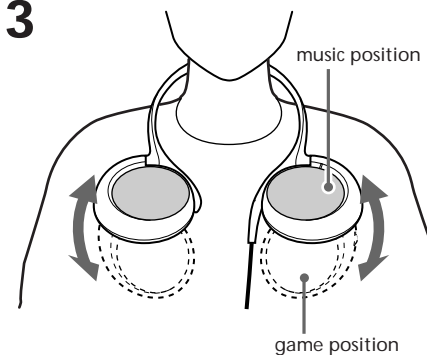

4

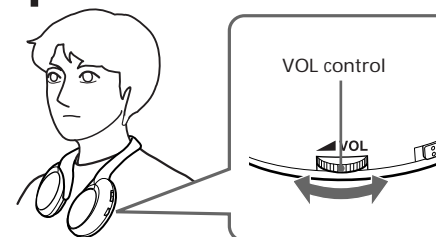

**4 Adjust the VOL control.**